

EASTLEIGH BOROUGH COUNCIL

Town and Country Planning Act 1990 (TCPA 1990)

STOPPING UP OR DIVERSION ORDER REFERENCE: The Eastleigh Borough Council (West End Footpath 502) Diversion Order 2019 ("the Order")

This Order is made by Eastleigh Borough Council under section 257 of the Town and Country Planning Act because it is satisfied that it is necessary to divert the footpath to which this Order relates in order to enable development described in Schedule One to be carried out in accordance with planning permission granted under Part III of the Town and Country Planning Act 1990 by the Council on 14 June 2017 under reference F/15/77718.

BY THIS ORDER:

1. The footpath over the land shown by a bold black line on the attached map and described in Part One of Schedule Two to this order shall be diverted as provided below.
2. There shall be created to the reasonable satisfaction of Eastleigh Borough Council an alternative highway for use as a replacement for the said footpath as provided in Part Two of Schedule Two and shown by black dashes on the attached map.
3. This Order shall come into force on the date on which notice that it has been confirmed is first published in accordance with Part II of Schedule 14 to the TCPA 1990 or the date on which the Council has certified that the terms of Article 2 of this Order have been complied with, whichever is the later and may be cited as The Eastleigh Borough Council (West End Footpath 502) Diversion Order 2019.
4. Where immediately before the date on which the footpath is diverted there is apparatus under, in on, over, along or across it belonging to statutory undertakers for the purpose of carrying on their undertaking, the undertakers shall continue to have the same rights in respect of the apparatus as they then had.

Made: 18 April 2019

The Common Seal of EASTLEIGH
BOROUGH COUNCIL was hereto
affixed in the presence of:

Legal Services Manager



11285

SCHEDULE ONE

THE DEVELOPMENT

F/15/77718

Construction of 98no. dwellings with access from Barbe Baker Avenue and Barnsland, associated landscaping, parking, new footpath, children's play area, attenuation pond and diversion of 3no. public rights of way.

SCHEDULE TWO

PART ONE

Description of Site of Existing Path

An area of highway known as West End Footpath 502 being shown as a bold black line between points A and C (a distance of approximately 197 metres) as shown on the attached plan.

PART TWO

Description of Site of Alternative Highway

A footpath of the route shown dashed black between points A-B-C (a distance of approximately 197 metres) as shown on the attached plan.

The width of the said alternative highway is 2 metres.

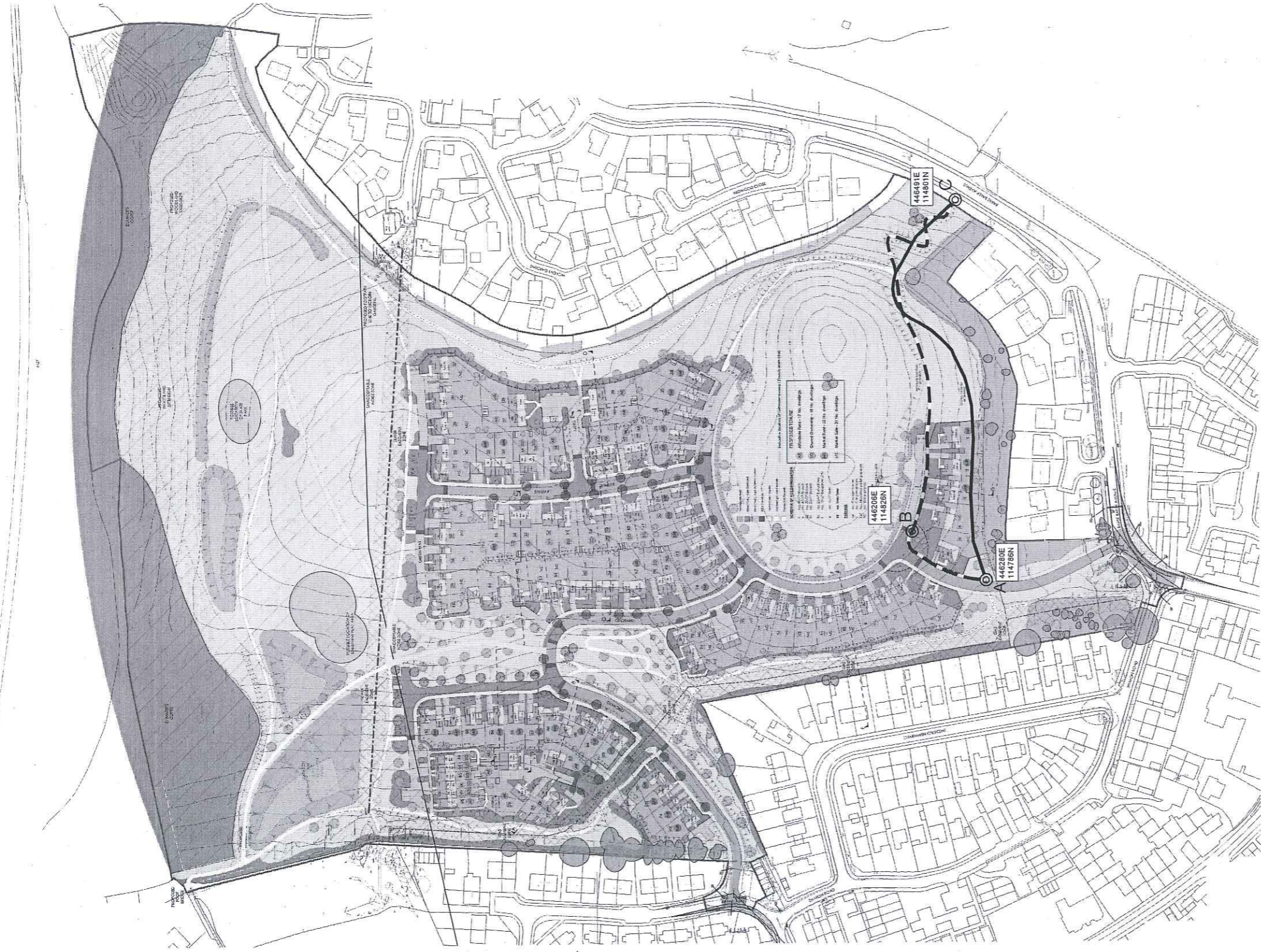

HATCH FARM, WEST END
PUBLIC FOOTPATH PROPOSALS PLAN



SECTION	LENGTH (m)
A-B	54m
B-C	143m
A-C	197m

- FOOTPATH TO BE CREATED
- EXISTING FOOTPATH (to be extinguished)

